

FIRST FLOOR - PROPOSED GENERAL ARRANGMENT
SCALE 1:50@A1

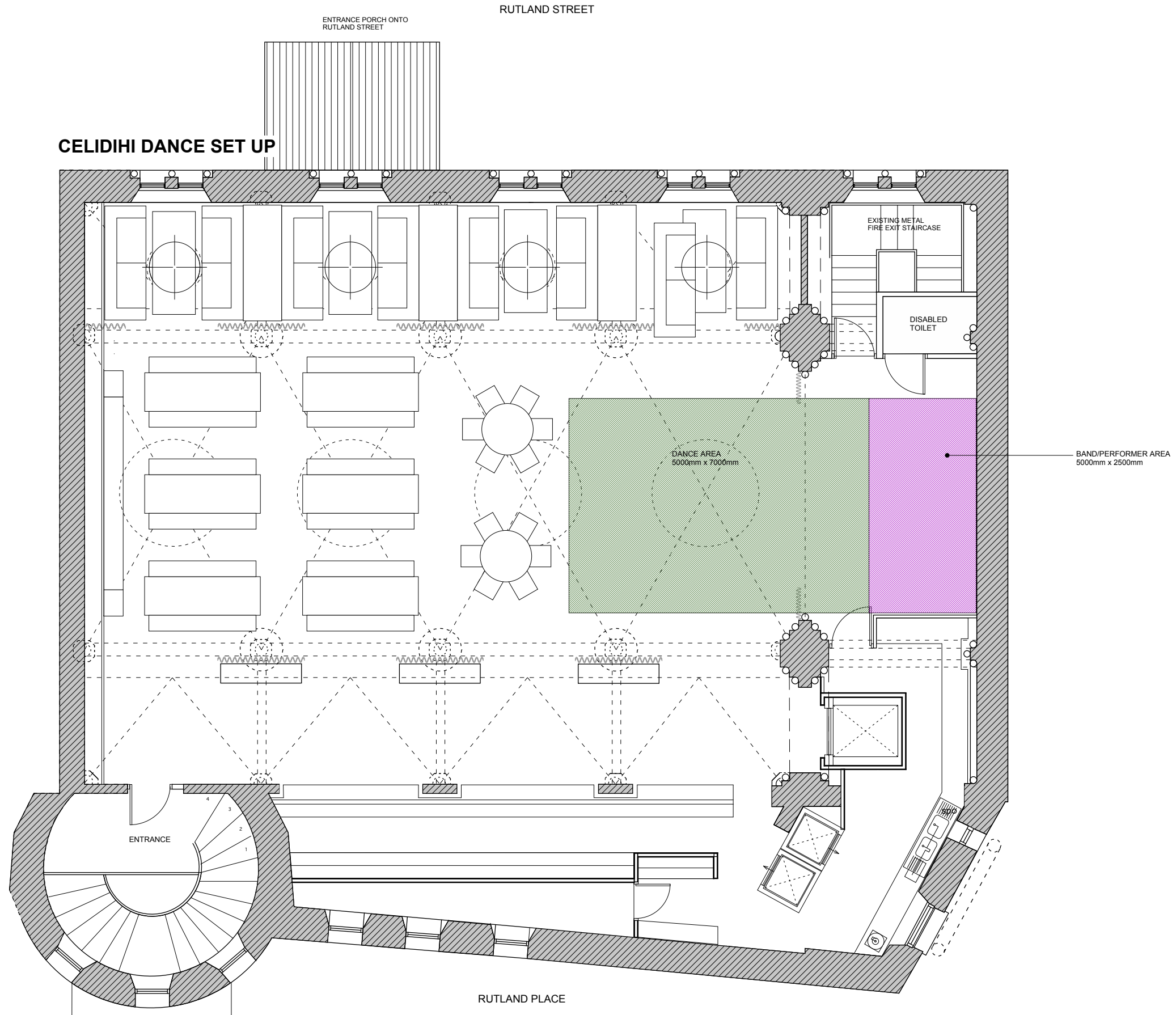

- Notes:
1. Contractor must assure himself to the full intent and purpose of the drawings and specifications.
 2. Contractor to check all drawn dimensions before starting work or fabrication. Do not diverge from drawings or specifications without notifying the Architect / Interior Designer and receiving express approval for alterations.
 3. Do not scale off drawings.
 4. This drawing is to be read in conjunction with all related drawings by the Architect, Interior Designer, Structural Engineer and M&E Engineer and any other relevant information.
 5. All site sizes to be confirmed by contractor prior to manufacture.
 6. Contractor to supply shop drawings prior to manufacture.
 7. Contractor to supply certification as necessary to the satisfaction of the respective statutory authorities.
 8. Contractor to ensure that all contract works are fit for purpose and in full accordance with respective codes of practice, national building standards and building industry regulations.
 9. Architect / Interior Designer to be notified in writing of any discrepancies and contractor to obtain instructions before proceeding.

Rev	Date	Notes	D	C
-	-	-	-	-

Client	G1 GROUP		
Project	Berkeley, Edinburgh		
Title	First floor - Proposed general arrangement		
Job No.	G_565		
Dwg No.	201	Rev.	A
Date	23/7/08	Scale	1:50 @ A1
Drawn by		Checked	-

Use figured dimensions only. Contractor to check all sizes on site. Do not scale from drawing. Copyright of design and drawing reserved.

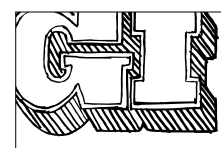

Graven Images
 175 Albion Street
 Glasgow G1 1RU
 Tel +44 (0)141 552 6626
 Fax +44 (0)141 552 0433
 www.graven.co.uk